

NORTH FRANCOIS LAKE HIGHWAY NO.35 PLAN 7147

COLLEYMOUNT HIGHWAY NO.21

FRANCOIS LAKE

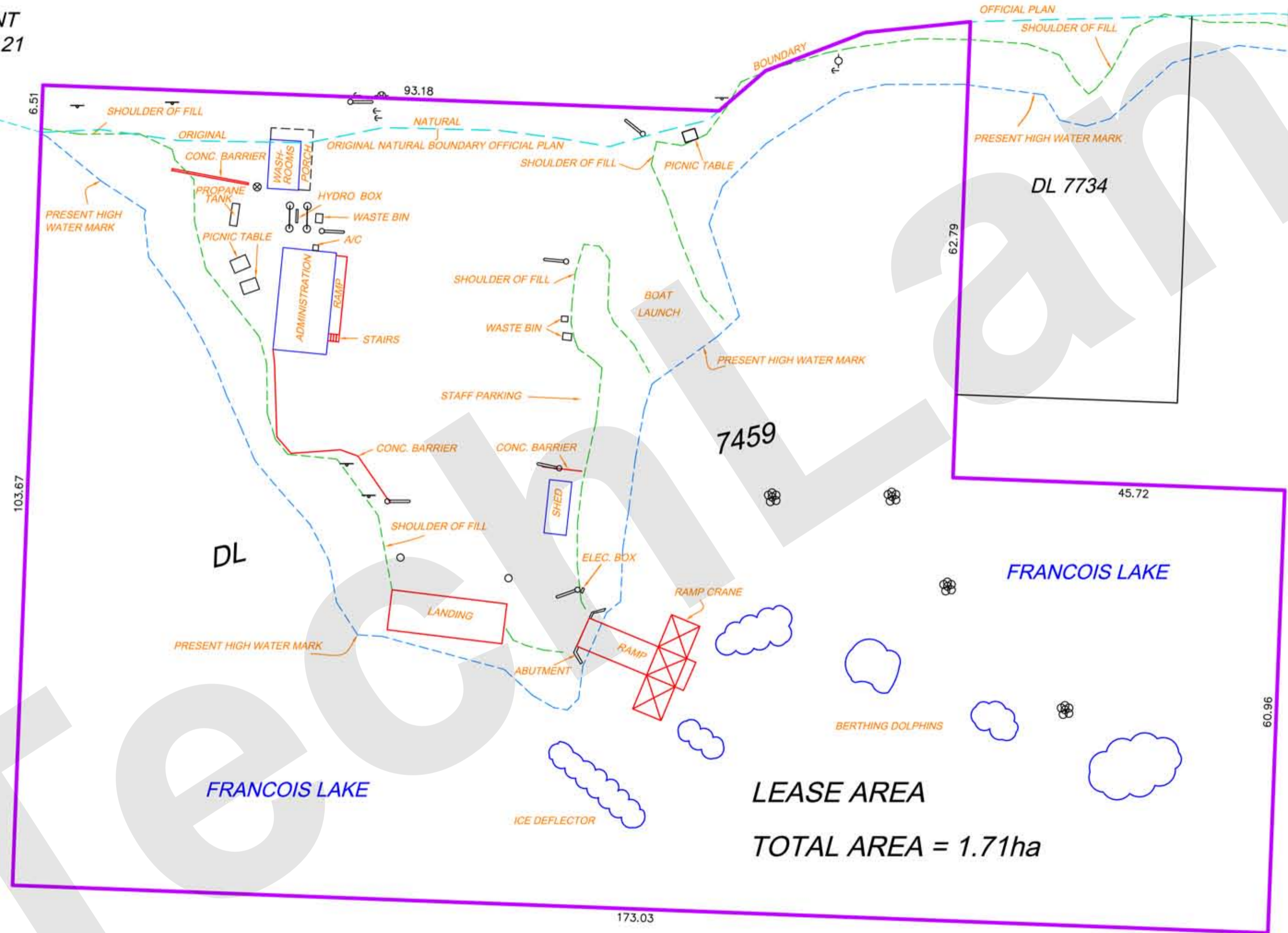

The intended plot size of this plan is 560mm in width by 432mm in height (C size) when plotted at a scale of 1:500.

Distances are horizontal ground level distances and decimals thereof unless otherwise denoted.
BCGS 93K.002

LEGEND	
	LAMP STANDARD
	GUY WIRE
	SIGN
	MANHOLE
	HYDRO POLE
	ANCHOR POLE
	CLUSTER DOLPHINS
	BOLLARDS

LEASE AREA
TOTAL AREA = 1.71ha

This plan lies within the Regional District of Bulkley Nechako.

THIS DRAWING AND DESIGN IS THE PROPERTY OF SANGHA GEOMATICS & LAND SURVEYING INC. (SANGHA) AND SHALL NOT BE USED, REUSED OR REPRODUCED WITHOUT THE CONSENT OF SANGHA. SANGHA WILL NOT BE HELD RESPONSIBLE FOR THE IMPROPER OR UNAUTHORIZED USE OF THIS DRAWING AND DESIGN. THIS DRAWING AND DESIGN HAS BEEN PREPARED FOR THE CLIENT IDENTIFIED, TO MEET THE STANDARDS AND REQUIREMENTS OF THE APPLICABLE PUBLIC AGENCIES AT THE TIME OF PREPARATION. SANGHA ITS EMPLOYEES, SUBCONSULTANTS AND AGENTS WILL NOT BE LIABLE FOR ANY LOSSES OR OTHER CONSEQUENCES RESULTING FROM THE USE OR RELIANCE UPON, OR ANY CHANGES MADE TO, THIS DRAWING, BY ANY THIRD PARTY, INCLUDING CONTRACTORS, SUPPLIERS, CONSULTANTS AND STAKEHOLDERS, OR THEIR EMPLOYEES OR AGENTS WITHOUT SANGHA'S PRIOR WRITTEN CONSENT. INFORMATION ON EXISTING UNDERGROUND FACILITIES MAY NOT BE COMPLETE OR ACCURATE. SANGHA ITS EMPLOYEES AND DIRECTORS ARE NOT RESPONSIBLE NOR LIABLE FOR THE LOCATION OF ANY UNDERGROUND CONDUITS, PIPES, CABLES OR OTHER FACILITIES WHETHER SHOWN OR OMITTED FROM THIS PLAN. PRIOR TO CONSTRUCTION CONTRACTOR SHALL EXPOSE LOCATIONS OF ALL EXISTING FACILITIES BY HAND DIGGING OR HYDROVAC AND ADVISE THE ENGINEER OF POTENTIAL CONFLICTS.

MINISTRY OF TRANSPORTATION AND INFRASTRUCTURE

Drawing No.

2017147 - NORTH SIDE

Project Number	Rev.
2017147	0

Rev	Date	Description	Survey	Drawn	App'd
0	2017-11-29	SITE PLAN	MS/JK	MS	MS